

ROTATING EYEBOLT H.T. - RINGSCHRAUBE H.T. - GOLFARE GIREVOLE H.T.

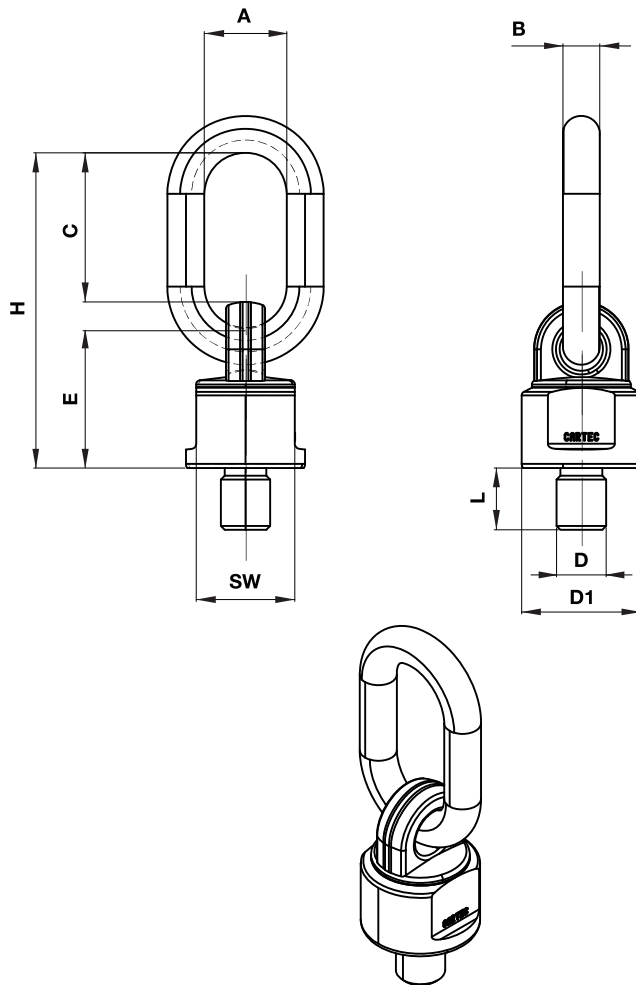

Notes

Can be oriented at **360°**.

Available on demand **-40°C**.

**CAN BE ORIENTED DURING
LOADING**



FORESEEN USE

Turning eyebolt needed to lift loads to assemble to the load itself with specific threaded hole generally used to turn or tilt heavy loads.

- Safety coefficient 4 in all loading directions
- Designed, tested and certified in compliance with the technical directives GS-OA 15-04 – EN 1677
- Suitable for safe lifting in compliance with the machinery directive 2006/42/EC
- Tested at 100 % magnaflux
- Tested at 20.000 stress cycles
- Can be oriented at 360° with self aligning tilting ring at 180°
- Assembled with spheres to make load orientation easier
- On the axial pull there can be variation of +/-5° with a 10% decrease in capacity

Accordingly with the requirements of "DGUV – German institution for security" please use the device with the screw supplied, if replaced OMCR Srl disclaims any and all responsibility or liability.

**Movement suitable for
continuous rotation during loading**



Art.	Screw Dim.
B03.20.	010

OMCR CODE	Size (mm)	W.L.L. (t)	A (mm)	B (mm)	C (mm)	E (mm)	H (mm)	SW (mm)	D1 (mm)	Weight (Kg)
B03.20.008	M8x16	0,3	30	13	46	50	105	30	38	0,48
B03.20.010	M10x18	0,5	30	13	46	50	105	30	38	0,48
B03.20.012	M12x18	0,7	30	13	46	50	105	30	38	0,5
B03.20.016	M16x20	1,4	30	13	46	50	105	30	38	0,53
B03.20.020	M20x30	2,5	34	16	57	61	131	40	50	1,05
B03.20.024	M24x30	4	40	18	70	68	153	48	58	1,63
B03.20.030	M30x35	6,7	45	22	65	71	156	70	80	2,85
B03.20.036	M36x54	10	50	23	91	86	200	80	90	4,62
B03.20.042	M42x63	12,5	50	23	91	86	200	80	90	5,2
B03.20.045	M45x60	12,5	50	23	91	86	200	80	90	5,2
B03.20.048	M48x60	17	70	32	120	112	262	100	120	10,9
B03.20.056	M56x78	18	70	32	120	112	262	100	120	10,9
B03.20.064	M64x96	20 (25)	70	32	120	112	262	100	120	10,9
B03.20.090	M90x135	40	90	45	124	165	333	140	170	29

WORKING LOAD LIMIT W.L.L. (t)

OMCR CODE	Size (mm)											Max tightening couple (Nm)
		0° Single leg	0° 2 legs	90° Single leg	90° 2 legs	0-45° 2 legs		45-60° 2 legs		0°-45° 3/4 legs		
B03.20.008	0,3 t-M8x16	0,6	1,2	0,3	0,6	0,42	0,3	0,3	0,63	0,45	0,3	16
B03.20.010	0,5 t-M10x18	1	2	0,5	1	0,75	0,5	0,5	1	0,75	0,5	16
B03.20.012	0,7 t-M12x18	1,4	2,4	0,7	1,4	1	0,7	0,7	1,4	1	0,7	28
B03.20.016	1,4 t-M16x20	2,8	5,6	1,4	2,8	2	1,4	1,4	3	2,1	1,4	70
B03.20.020	2,5 t-M20x30	5	10	2,5	5	3,5	2,5	2,5	5,3	3,7	2,5	135
B03.20.024	4 t-M24x30	8	16	4	8	5,6	4	4	8,4	6	4	230
B03.20.030	6,7 t-M30x35	12	24	6,7	13,4	9,4	6,7	6,7	14	10	6,7	465
B03.20.036	10 t-M36x54	15	30	10	20	14	10	10	21,2	15	10	814
B03.20.042	12,5 t-M42x63	15	30	12,5	25	17,5	12,5	12,5	26,2	18,7	12,5	1304
B03.20.045	16 t-M45x60	25	50	17	34	23,5	17	17	31,5	22,4	15	1670
B03.20.048	17 t-M48x60	25	50	18	36	25,2	18	18	35,7	25,5	17	1981
B03.20.056	18 t-M56x78	25	50	18	36	25,2	18	18	37	27	18	3000
B03.20.064	20 t-M64x96	25	50	20	40	28	20	20	42,5	30	20	4738
B03.20.090	40 t-M90x135	50	100	40	80	56	40	40	85	60	40	14000

Lifting Elements