

## REPLACEMENT LIFTING PIN FOR LIFTING BRACKET FCA ERSATZTRAGBOLZEN FÜR TRAGWANGE FCA PERNO DI RICAMBIO PER STAFFA DI SOLLEVAMENTO FCA



Respect the max load  
Maximale Nutzlast beachten  
Rispettare il carico Max

### WARNING - ACHTUNG - ATTENZIONE:

For safety reason, please consider always that the weight of the die has to be supported by just 2 lifting pins.

Aus Sicherheitsgründen stets berücksichtigen, dass zwei Tragbolzen das gesamte Werkzeuggewicht tragen müssen.

Per ragioni di sicurezza, considerare sempre che il peso dello stampo deve essere sopportato da 2 soli perni.

According - Nach - Secondo:  
B01.15

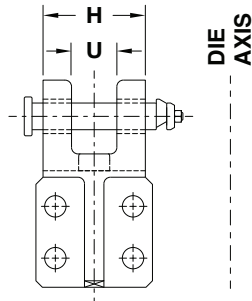

### Notes

**Material:** CK45



WEB

WEB

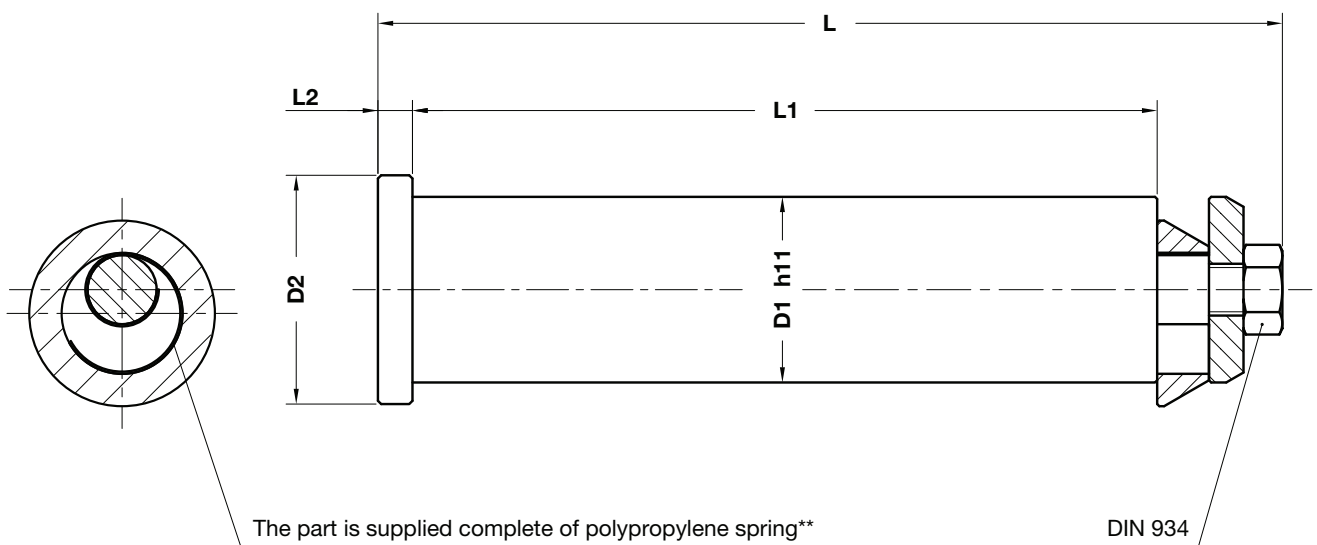

Lifting Elements

ORDER EXAMPLE	Art.	D1=60
	B02.42.	60

OMCR CODE	Max load (kg)	Max die weight (kg)	D1	D2	H	L	L1	L2	U
B02.42.15	600	1200	15,6	25	70	102,5	77	6	30
B02.42.20	1000	2000	20,6	30	79	113,5	86	6	35
B02.42.25	2000	4000	25,6	35	90	128,5	100	6	40
B02.42.33	4000	8000	33	43	125	166,5	135	6	55
B02.42.43	7000	14000	43	53	160	210,5	175	8	60