

SINTERED STEEL WEAR PLATE TYPE VDI 3357
GLEITPLATTE STAHL MIT SINTERGLEITFLÄCHE TIP VDI 3357
PIASTRA GUIDA IN ACCIAIO SINTERIZZATO TIPO VDI 3357

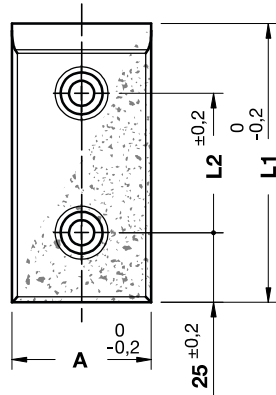

FORM A

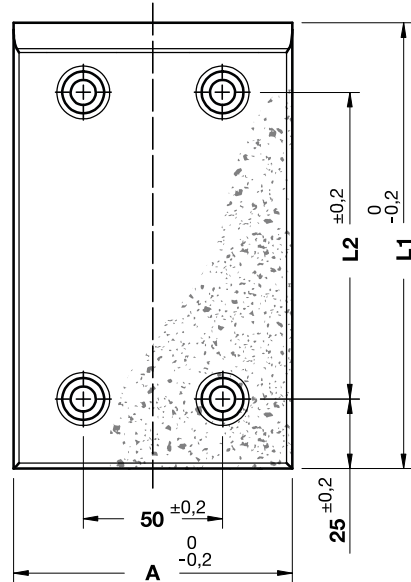

FORM B

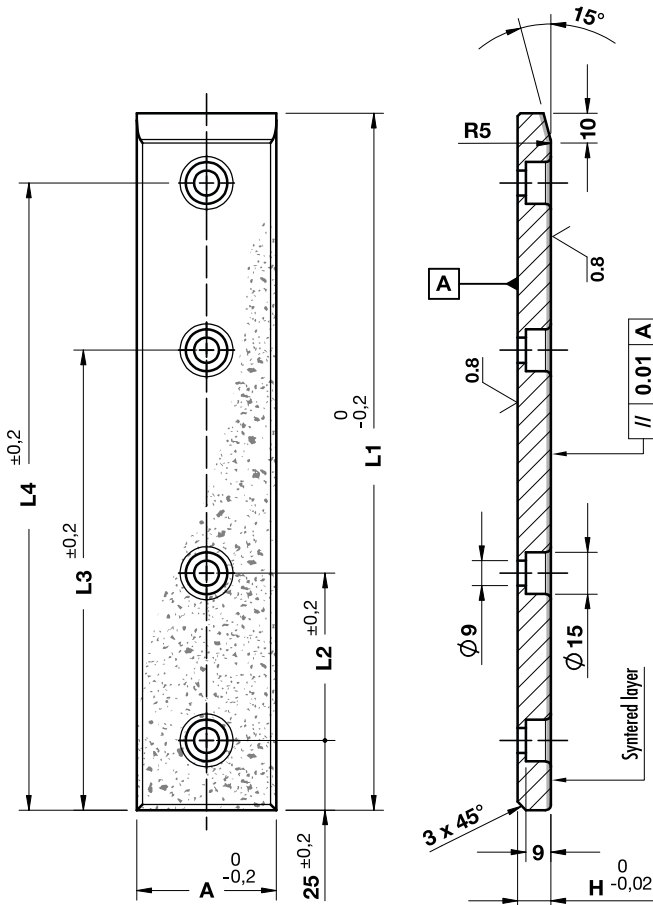

FORM C

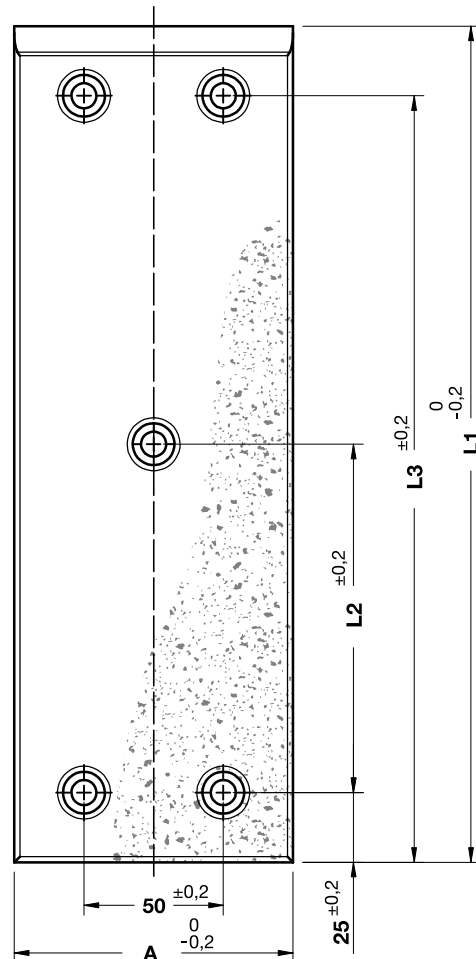

FORM D

Notes

Material: Steel + SINT300®

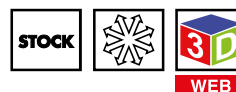

	Art.	A=50	H=12	L1=80
	E50.06.	050	12	080

OMCR CODE	A	H	L1	L2	L3	L4	FORM
E50.06.03012080	30	12	80	30	-	-	A
E50.06.03012100	30	12	100	50	-	-	A
E50.06.03012125	30	12	125	75	-	-	A
E50.06.03012160	30	12	160	110	-	-	A
E50.06.03012200	30	12	200	150	-	-	A
E50.06.04012080	40	12	80	30	-	-	A
E50.06.04012100	40	12	100	50	-	-	A
E50.06.04012125	40	12	125	75	-	-	A
E50.06.04012160	40	12	160	110	-	-	A
E50.06.04012200	40	12	200	150	-	-	A
E50.06.05012080	50	12	80	30	-	-	A
E50.06.05012100	50	12	100	50	-	-	A
E50.06.05012125	50	12	125	75	-	-	A
E50.06.05012160	50	12	160	110	-	-	A
E50.06.05012200	50	12	200	150	-	-	A
E50.06.05012250	50	12	250	60	165	225	C
E50.06.05012300	50	12	300	80	195	275	C
E50.06.05012350	50	12	350	100	225	325	C
E50.06.05012400	50	12	400	120	255	375	C
E50.06.06012080	60	12	80	30	-	-	A
E50.06.06012100	60	12	100	50	-	-	A
E50.06.06012125	60	12	125	75	-	-	A
E50.06.06012160	60	12	160	110	-	-	A
E50.06.06012200	60	12	200	150	-	-	A
E50.06.08012080	80	12	80	30	-	-	A
E50.06.08012100	80	12	100	50	-	-	A
E50.06.08012125	80	12	125	75	-	-	A
E50.06.08012160	80	12	160	110	-	-	A
E50.06.08012200	80	12	200	150	-	-	A
E50.06.10012125	100	12	125	75	-	-	B
E50.06.10012160	100	12	160	110	-	-	B
E50.06.10012200	100	12	200	150	-	-	B
E50.06.10012250	100	12	250	200	-	-	B
E50.06.10012300	100	12	300	125	275	-	D