

NG 24 x 1.5

VDI 3004	075.90.40 (FCA)	W-DX35-60M (Ford)	90.25.95 (GM)
90.25.96 (GM)	39D 549 (VW)		



ACTIVE SAFETY



USAS



OPAS

* F_{1i} = Isothermal end force at 100% Cu
 ** F_{1p} = Polytrophic end force at 100% Cu
 p. 16

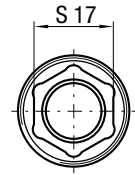
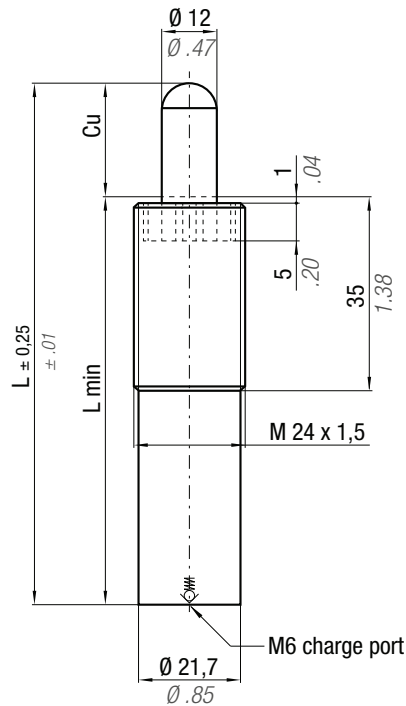

cod. 39CM01A (optional)

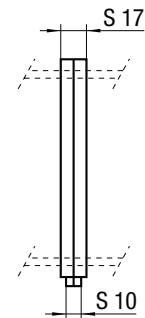

CODE	Cu		L		L min		~Kg		~lb		PED 2014/68/EU	Force color code	P		F0 Initial force ± 5%		F _{1i} End force*	F _{1p} End force**
	mm	inch	mm	inch	mm	inch			bar	psi			daN	lb	+20°C	+68°F		
NG 24 x 1,5-010-A-...	10	0.39	80	3.15	70	2.76	0,15	0.33	✓			GR	20	290	23	52	1,57 x F0	2,01 x F0
NG 24 x 1,5-020-A-...	20	0.79	100	3.94	80	3.15	0,17	0.37	✓			BU	40	580	45	101	1,57 x F0	2,01 x F0
NG 24 x 1,5-030-A-...	30	1.18	120	4.72	90	3.54	0,19	0.42	✓			BR	60	870	67	151	1,57 x F0	2,01 x F0
NG 24 x 1,5-040-A-...	40	1.57	140	5.51	100	3.94	0,22	0.49	✓			RD	75	1088	85	191	1,57 x F0	2,01 x F0
NG 24 x 1,5-050-A-...	50	1.97	160	6.30	110	4.33	0,24	0.53	✓			YW	150	2175	170	382	1,57 x F0	2,01 x F0
NG 24 x 1,5-060-A-...	60	2.36	180	7.09	120	4.72	0,26	0.57	✓			BK	10-150	145-2175	11-170	25-382	1,57 x F0	2,01 x F0
NG 24 x 1,5-070-A-...	70	2.76	200	7.87	130	5.12	0,28	0.62	✓									
NG 24 x 1,5-080-A-...	80	3.15	220	8.66	140	5.51	0,29	0.64	✓									
NG 24 x 1,5-100-A-...	100	3.94	260	10.24	160	6.30	0,31	0.68	✓									

P = nominal charging pressure

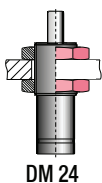

DM 24

HOW TO ORDER

p. 31

INSTALLATION GUIDELINE

p. 205